

#### MEMBRANE SPECIFICATION

**Colour:**  
Black

**Weight:**  
230 g/m<sup>2</sup>

**Dimensions:**  
Roll size: 1.5m x 50m

#### OVERVIEW

- Probreathe A2 is an airtight woven glass fibre membrane with a PU coating. Probreathe A2 combines breathability, good water resistance and airtightness in one membrane. Probreathe A2 has a Reaction to Fire classification of A2-s1,d0 when installed free-hanging or on a minimum Class A2,s1,d0 substrate.

#### STORAGE & HANDLING

- Store the rolls horizontally in a cool, dry place. Handle the material carefully, ensuring that the membrane is not folded or creased. When unrolling the membrane, ensure that the substrate is clean, dry and free of dust, debris or liquid contaminants.

#### TOOLS REQUIRED

- Utility Knife
- Measuring Tape
- Scissors
- Clean Cloth
- 50mm Roller
- Smoothing Brush

#### SUBSTRATE PREPARATION

- Substrate condition is critical for Probreathe FR Duo adhesion.
- The substrate temperature must be above 5°C.
- Surfaces must be clean, dry and free from all bond-breaking contaminants or sharp protrusions that may hinder adhesion to the substrate.
- Remove any loose dust or dirt from the substrate by wiping with a clean dry cloth or brush.
- Remove and replace any damaged structural wall components.

#### ACCESSORIES REQUIRED

- Probreathe FR Duo Tape (50mm x 50m)
- Probreathe FR Tape (75mm x 25m)

**As each construction is unique, you are advised to contact the A. Proctor Group Technical Support for advice and guidance on installations not covered in this guide on 01250 872261.**

#### PHYSICAL PROPERTIES

Composition	Glass fibre fabric with black coating
Weight	230 g/m <sup>2</sup>
Reaction to fire	A2, s1, d0
Resistance to air penetration	0.006m <sup>3</sup> /(h x m <sup>2</sup> @ 50Pa)
Water vapour permeability	Sd = 0.095m
Width / Length / Thickness	1.5m / 50m / 0.23mm
Weight / roll	19kg
Packaging	Roll of 75m <sup>2</sup>
Quantity per pallet	36 rolls (2700m <sup>2</sup> )
<b>Accessories:</b>	
Probreathe FR Duo Tape	50mm x 50m
Probreathe FR Tape	75mm x 25m

#### KEY BENEFITS

- A2 Reaction to Fire Classification
- Increased airtightness over traditional breather membranes
- Vapour permeable membrane for use either directly onto sheathing or over insulation.
- Ideal for use in rainscreen/facade construction
- Suitable for applications over 18m (11m in Scotland)
- Robust & Durable
- Allows temporary protection of the building until the primary external covering is installed

## GENERAL INSTALLATION INFORMATION

- Appraise the area prior to installation to determine best installation methodology for Probreathe A2 membrane.
- Apply Probreathe FR Duo Tape to the substrate at 500mm centres - see Fig. 1.
- Optimal bonding is achieved when even pressure is applied to the Probreathe FR Duo Tape and Probreathe FR Tape using a 50mm roller.
- Do not remove the release liner on the Probreathe Duo Tape until you are ready to install the membrane - see Fig. 2.
- Probreathe A2 should be cut using a straight edge and a utility knife or sharp pair of scissors. Make sure that the work surfaces are clean, dry and free of dust, debris and/or liquid contaminants.
- Probreathe A2 must be installed with the black side facing outwards.
- Probreathe A2 must be installed uniformly without pulling to ensure even tension across and along the membrane.
- Probreathe A2 can be laid horizontally or vertically and is partially bonded back to the substrate using Probreathe FR Duo Tape, installed at 500mm centres - see Fig. 2 and 3.
- Ensure all perimeters of underlying Probreathe A2 are bonded back to the substrate with Probreathe FR Duo Tape - see Fig. 2 and 3.
- Horizontal overlaps - minimum 150mm ensuring the shingle effect is achieved.
- Vertical overlaps - minimum 100mm.
- Both sealed with Probreathe FR Tape.

**As each construction is unique, you are advised to contact the A. Proctor Group Technical Support for advice and guidance on installations not covered in this guide on 01250 872261.**

*The contents of this installation guide are provided by A. Proctor Group Limited (APG) in good faith for general information purposes only. The statements and data contained in this guide are not specific technical recommendations as to any particular design or application. APG give no warranty and accept no liability for its contents and the ultimate determination as to product suitability is the sole responsibility of the installer or end user. APG strongly recommends following the installation guidelines and the relevant Codes of Practice which are correct at the time of publication and results may vary depending on the particular design/and or application.*

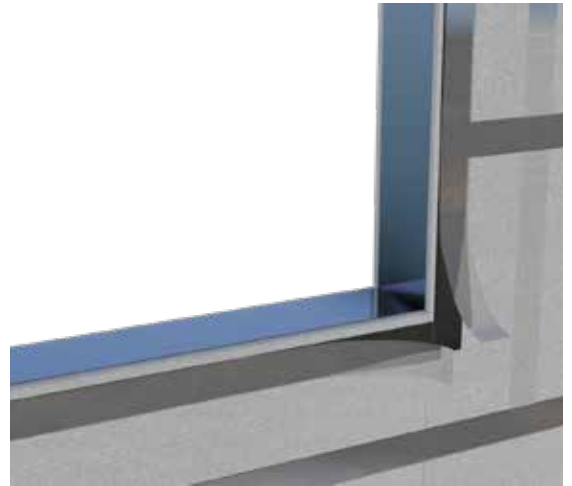

Fig. 1

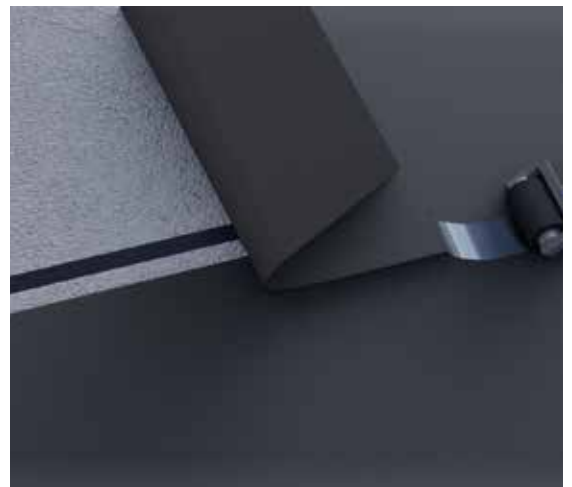

Fig. 2

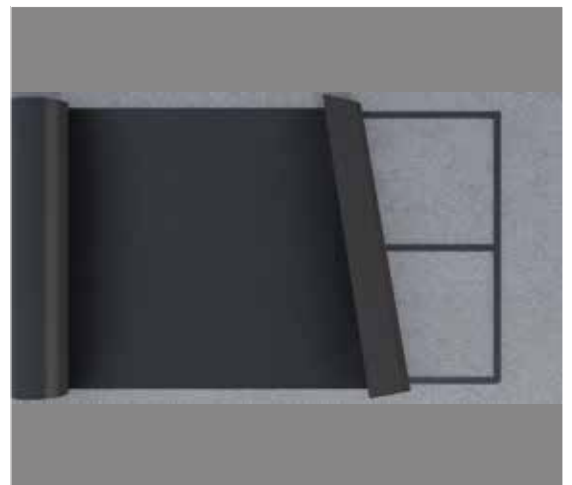

Fig. 3